



## USER MANUAL

InsulinSaver is a product developed to help insulin-treating diabetics get an idea of what temperatures the insulin is, or has been, exposed to.

InsulinSaver is set to give a signal at temperatures that several insulin manufacturers have set as the maximum / minimum temperature, +2°C to +30°C.

The battery life of an InsulinSaver is 12-18 months, under normal conditions. 12-month warranty applies, as long as the unit's battery hasn't been exhausted.



# 1. Note the Date:

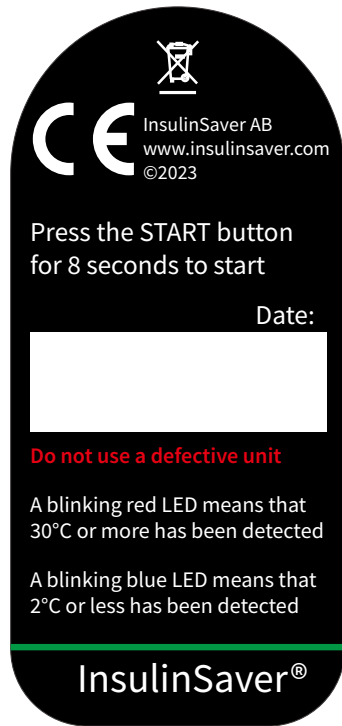

Note the date when your InsulinSaver was started

Note the date you started your InsulinSaver to keep track of battery life. You could do this on the back of your InsulinSaver.

## 2. Start your InsulinSaver:

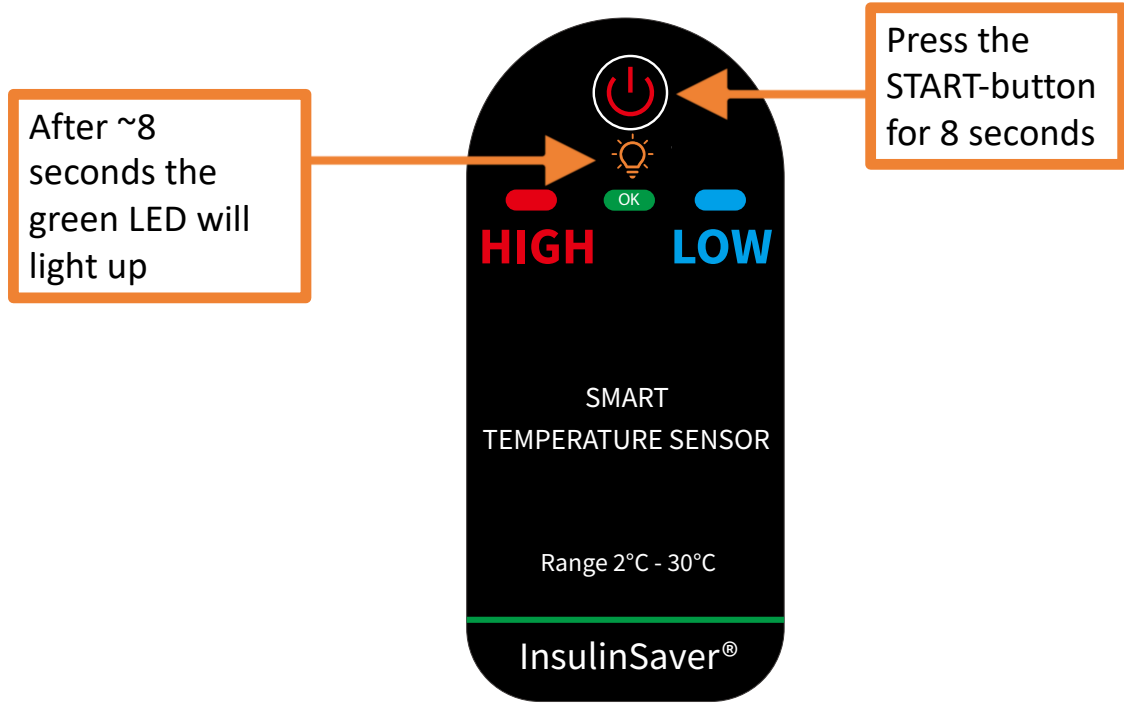

To start your InsulinSaver, hold down the START button for 8 seconds and the green LED will light up.

Your InsulinSaver starts recording and analyzing temperature after 10 minutes.

### 3. Check that your InsulinSaver is running:

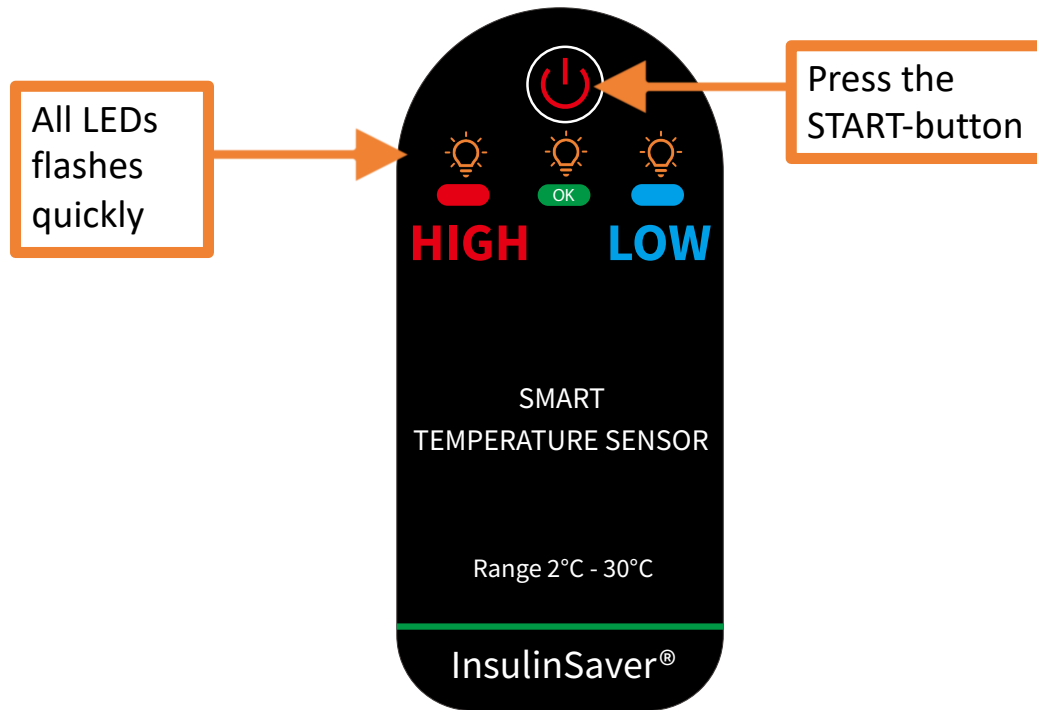

Press the START button once.  
If your InsulinSaver is running, all three LEDs will flash.

## 4. How your InsulinSaver signals to you:

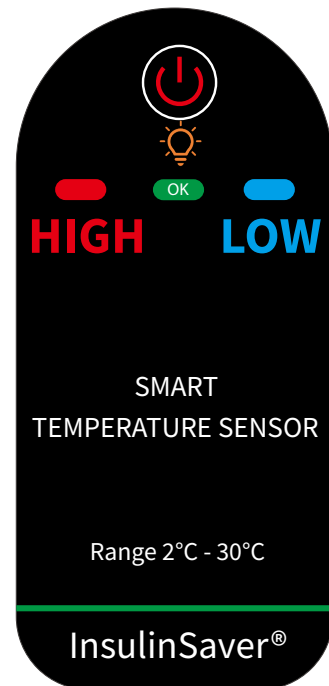

### Temperature within 2-30°C

The green LED, in the middle, signals every 10 minutes that your InsulinSaver is, and has been, at an approved temperature.

*Note: No need to wait 10 minutes, see section 3.*

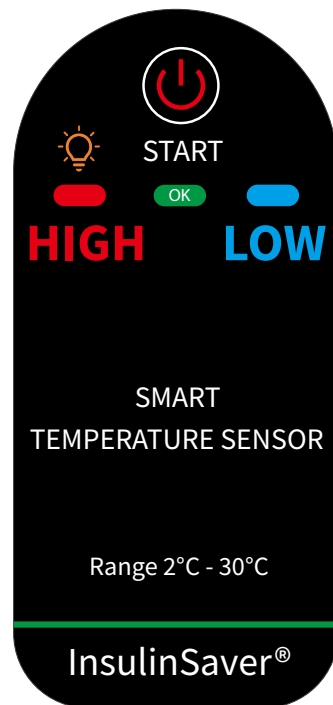

## Temperature above 30°C

If your InsulinSaver has been exposed to a temperature above 30°C, the red LED will flash repetitive.

*Note: Your InsulinSaver continues to blink until you turn it off. When you turn it back on, the blinking is gone.*

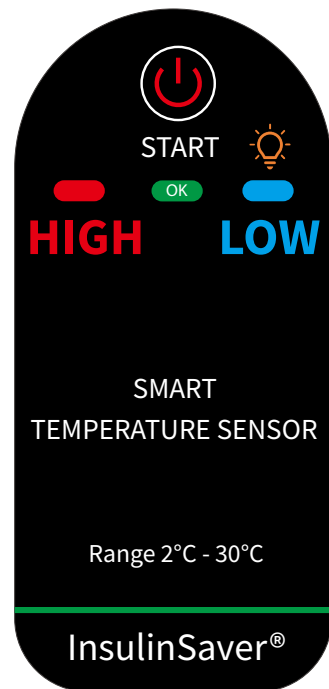

## Temperature below 2°C

If your InsulinSaver has been exposed to a temperature below 2°C, the blue LED will flash repetitive.

*Note: Your InsulinSaver continues to blink until you turn it off. When you turn it back on, the blinking is gone.*

## 5. Turn off/reset your InsulinSaver:

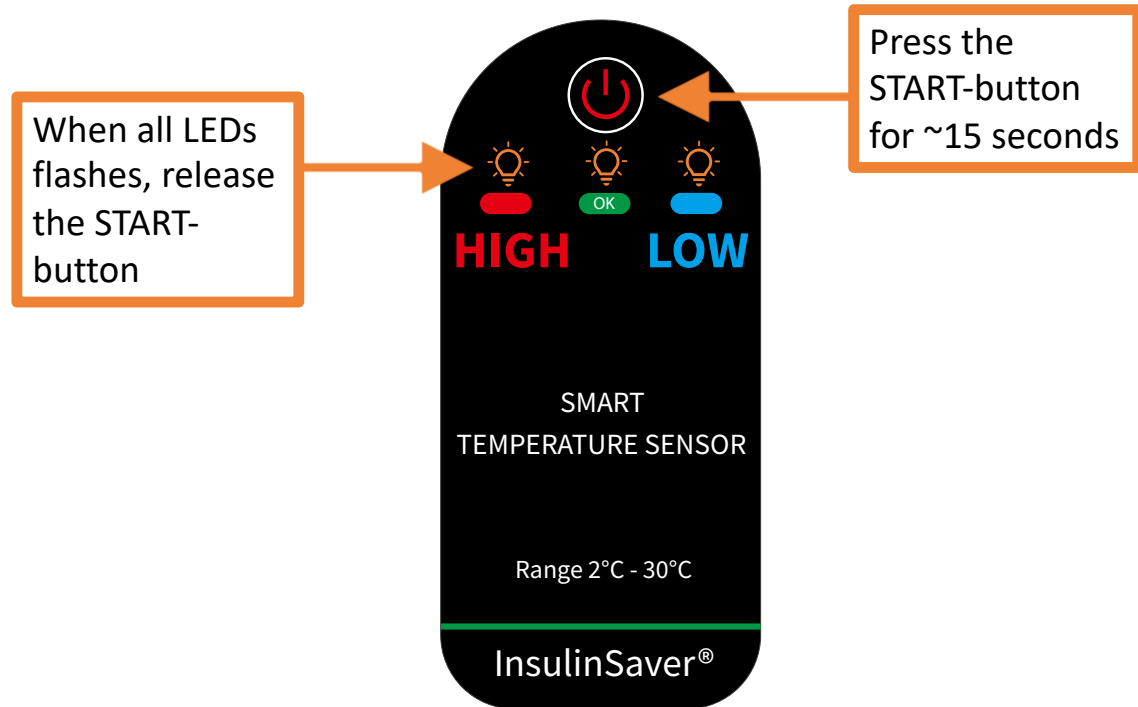

To turn off your InsulinSaver, press and hold the START button for approx. 15 seconds. When all the LEDs are flashing, release the START button. All alarms will be restored.

*If the intention was to reset the unit, you can now proceed to start it again (see section 2)*



## 6. Check that your InsulinSaver is turned off:

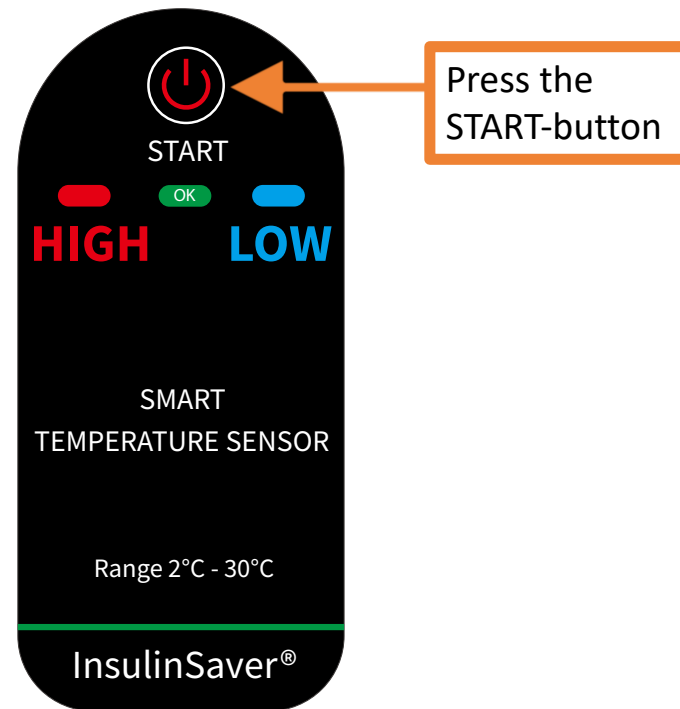

Press the START button once. If your InsulinSaver is off, no LEDs will flash.

## **NOTE!**

- **InsulinSaver is no guarantee that your insulin can be used in all situations**
- **InsulinSaver is an aid to increase your awareness of temperatures**
- **InsulinSaver does not withstand strong shocks or strong pressure**

## **WASTE DISPOSAL**

- **Do not throw your InsulinSaver in the household trash**
- **InsulinSaver is discarded as electronic waste**

**Battery Exchange:** <https://www.insulinsaver.com/battery-replacement>

InsulinSaver is provided “AS IS” WITHOUT WARRANTY OF ANY KIND, EITHER EXPRESS OR IMPLIED, INCLUDING, BUT NOT LIMITED TO, WARRANTIES OF MERCHANTABILITY, FITNESS FOR A PARTICULAR PURPOSE OR NONINFRINGEMENT OF THIRD PARTY RIGHTS.

V. 20240801